

AQUASTOP

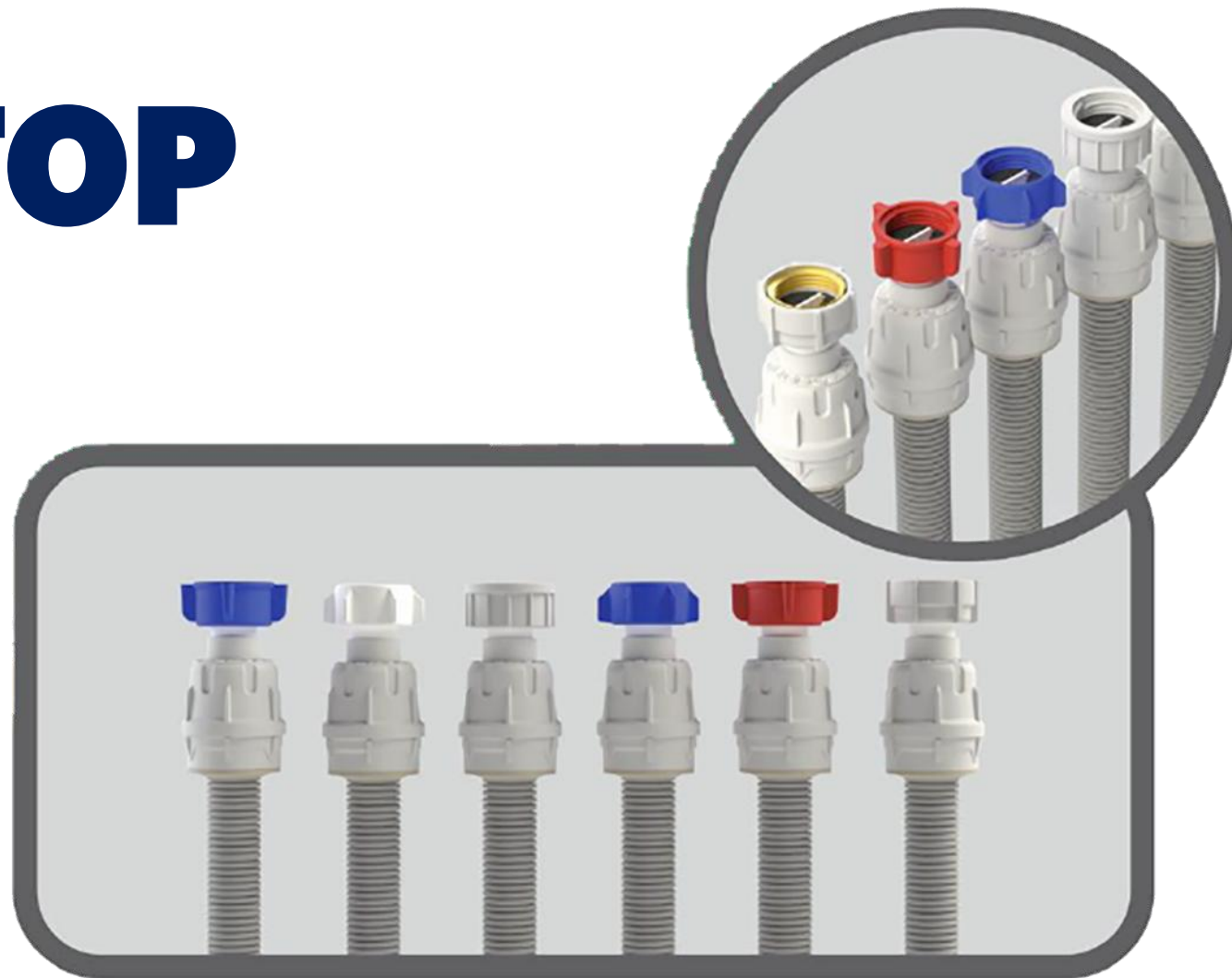

Usage

It is a product which is used to prevent flooding in case of a malfunction. It consists of a mechanic valve, an inner hose (PVC inlet hose) and a protective outer hose set. When a water leak happens in the inlet hose, the water is accumulated by the protective hose and it reaches the blockage mechanism in the valve so that the valve is closed and flooding is prevented. The mechanism works without any need of an electrical power supply.

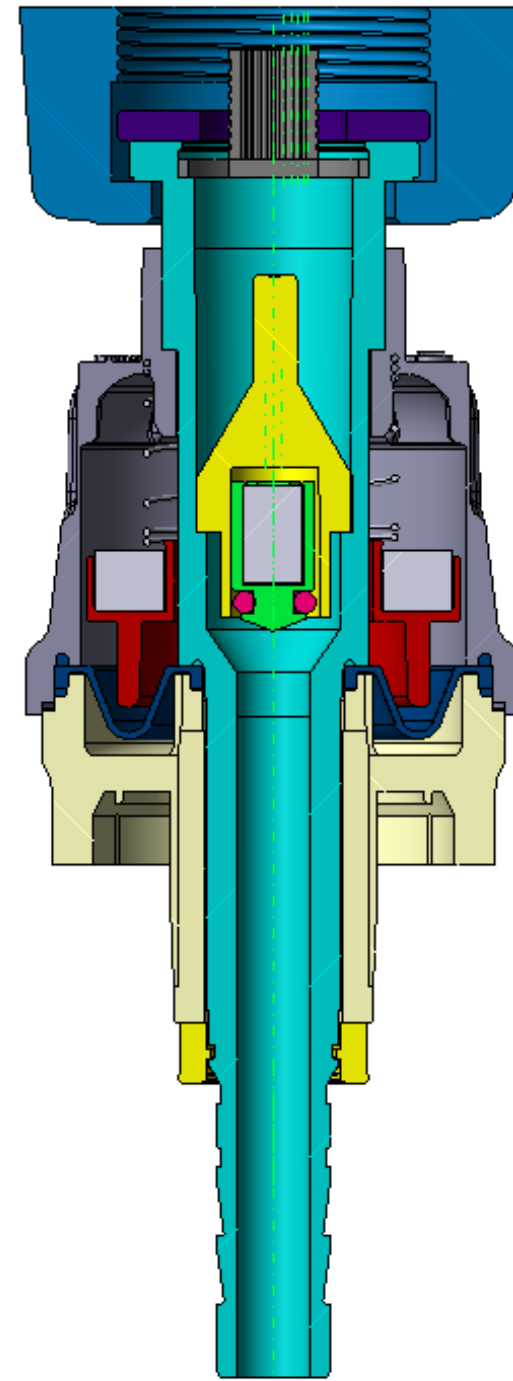

Features

- MAGNETIC SYSTEM WITHOUT SPONGES OR ELECTRICAL PARTS
- 100% TESTED (REVERSIBLE) SO PPM=0
- RELIABLE (MECHANICAL PARTS ONLY IN MOVEMENT)
- CHEAPER THAN ACTUAL SYSTEMS ON THE MARKET
- USEFUL FOR APPLIANCES (WASHING MACHINES, DISH WASHERS) BUT ALSO FOR MAIN SECTORS (COFFÈ MACHINES, INDUSTRIAL WASHING MACHINES, GENERALLY WHAT EMPLOY WATER SUPPLY)

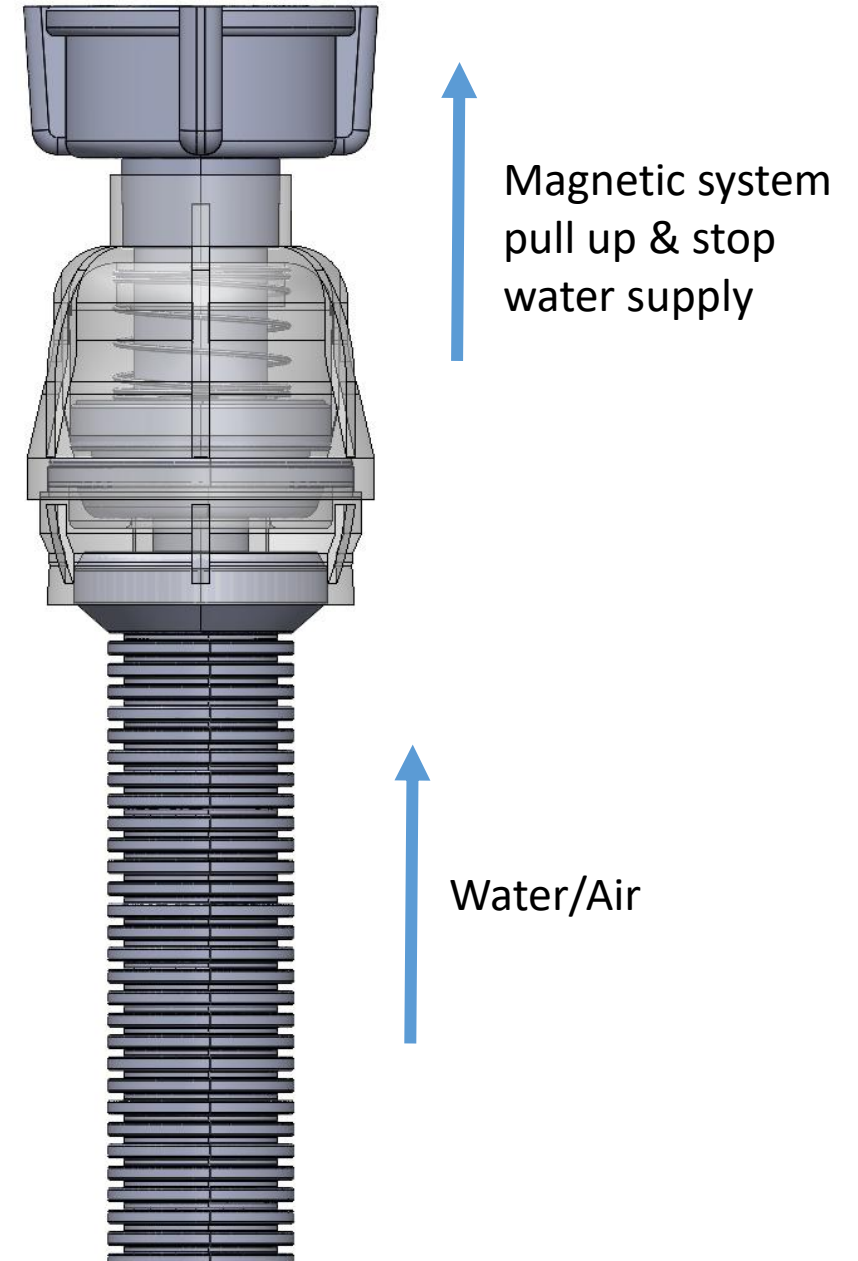

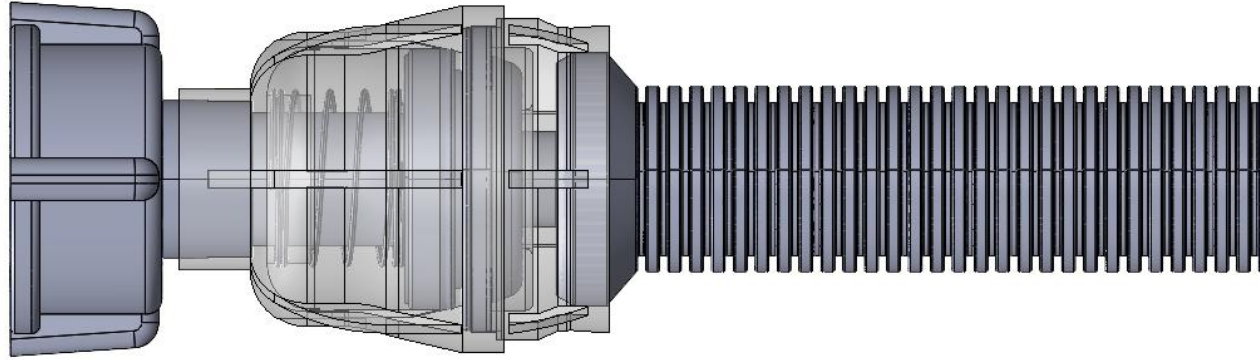

AQUASTOP CIMPLASTA

- MAGNETIC SYSTEM WITHOUT SPONGES OR ELECTRICAL PARTS
- 100% TESTED (REVERSIBLE) SO PPM=0
- RELIABLE (MECHANICAL PARTS ONLY IN MOVEMENT)
- CHEAPER THAN ACTUAL SYSTEMS ON THE MARKET
- FUNCTION WITH CHANGE OF PRESSURE (SO WHEN BREAK PIPE EVERYWHERE)



PRODUCTS ON THE MARKET

- SPONGE ONE SHOT (NO TEST AVAILABILITY)-ELECTRICAL SUPPLY
- FOR SPONGES IMPOSSIBLE TO TEST THE ASSEMBLY
- ELECTRICAL DEVICES WITH LONG LIFE PROBLEMS
- ELECTRICAL VERY EXPENSIVE, SPONGE MORE EXPENSIVE THAN MAGNET
- SPONGE NEED WATER FILLING SO HIGH DELAY FROM BREAK

Properties

- 100% Full Automatic Production
- 100% Leakage and Camera Control
- Middle Flexible
- High Chemical Endurance
- Minimum Bending Radius
- Good Resistant to Climate Impacts
- Preassembled Components
- Integrated Connectors
- RoHS, REACH, SVHC Compliance
- VDE Certificate

Material	PP, PVC, NBR, EPDM, PA 66
Water Supply Pressure	0,2-10 bar
Cold Water Working Temperature	5°C < t < 60°C
Hot Water Working Temperature	5°C < t < 90°C
Ambient Operating Temperature	5°C < t < 70°C
Hose Inner & Outer Diameter	9 x 13mm / 10 x 15mm
Leak Tightness Pressure	6 bar
Flow Rate	10 L/min
Thread of Nut	¾ ISO 228, ASME ¾ 11.5 NH
VDE Number	
Standard	EN 61770
Burst Pressure	60 bar

Contacts

Cimplasta Srl

6, Via Cascina Nuova

I21029 Vergiate (VA)

Phone +39 0331946136

Ref.Mr.Rossi Paolo

Email: paolo_rossi@cimplasta.it



IATF 16949
Certified Quality Management System
for the Automotive Industry
www.tuvsud.com/ms-cert

